

Units with this Floor Plan:

- 223, 229, 230, 232, 233, 236
- 323, 329, 330, 332, 333, 336
- 423, 429, 430, 432, 433, 436

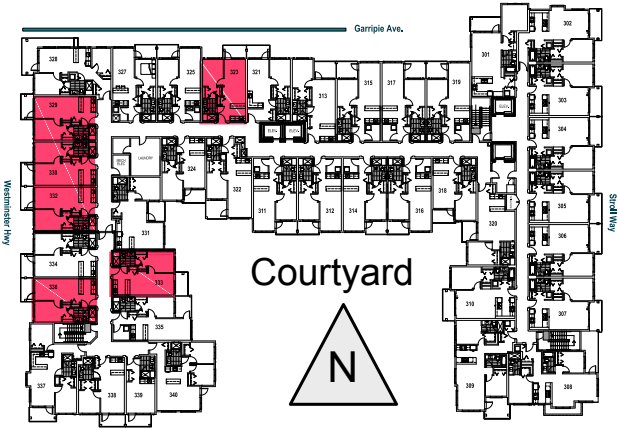

THE DEVELOPER RESERVES THE RIGHT TO MAKE MODIFICATIONS OR SUBSTITUTIONS
SHOULD THEY BE NECESSARY. ANY MEASUREMENTS PROVIDED ARE APPROXIMATE ONLY. E.&O.E.